

C7 Removable/Lockable Front Plate Instructions

Thank you for purchasing the most innovative front license plate holder for your C7 Corvette.

Installation:

- Screwdriver required
- 2 ½"x ¼" -20 bolts (included)

Optional:

- Small padlock(s)
- 1 or 2 3/16" bolts/nuts

Instructions:

- 1) Place the lower edge of plate bracket into lower grill opening (about a 45° angle).



- 2) Verify the lower tabs are INSIDE the grill.

CORRECT



INCORRECT

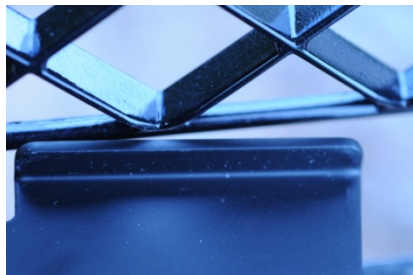

- 3) Rotate top tabs into position while depressing side latches fully.

Rubber

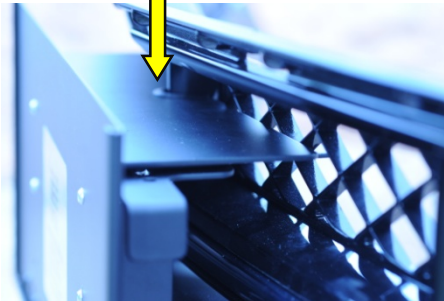
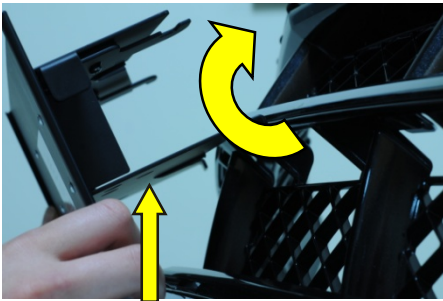

Rubber

- 4) Verify position of latch, and make sure top and bottom rubber grommets are in place, then press tabs in until frame is on the grill. Release and pull out tabs.



- 5) Verify that holes can be seen from top to ensure proper placement. If not, recheck lower tabs and upper tabs for correct position and adjust.

CORRECT

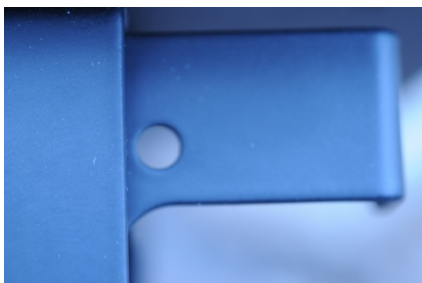

INCORRECT



- 6) Plate can be secured with bolts or padlock(s) if desired.
7) Slip license plate into frame and secure with 1/2" bolts.

NOTE: THIS IS DESIGNED FOR HOLDING PLATE ONLY. DO NOT ATTACH ANY LICENSE PLATE FRAME.

Innovative Automotive Products
fastlinetrackpro@gmail.com
303.888.6577