

#5	C5 / 6 Mild (same as GTO / V1)	Packing List
	Description	Quantity
o	MM Gen5 DRAFT can (2)	1
	-6AN inlet / outlet (600hp capacity)	
o	120* -6AN hose end	1
o	Straight -6AN hose end	1
o	FT 3/8 PCV hose	3
o	LS head mounting kit	1



**Press Gen5
breather all the
way down to
the can body.**

Drain Operation. Do not over-tighten!



Remove factory PCV valve assembly and tubing from vehicle.

If the car was originally equipped with a separate 'in-line' floating pcv valve, it must be reused in between can and intake manifold.

Mount can with supplied bracket and hardware to the cylinder head.

On some cars you will need to dismount the evap solenoid from the head, and optionally discard the evap metal bracket. Tuck evap tubing behind can.

On C5 check hood clearance before slamming hood!

You may need to use the slots in the bracket to lower the can.

You may need to trim fuel rail covers if used with this can, or space the bracket out accordingly.

Connect can to oem pcv port driver cover or valley plate.



**Unbolt evap solenoid
and unclip metal bracket**

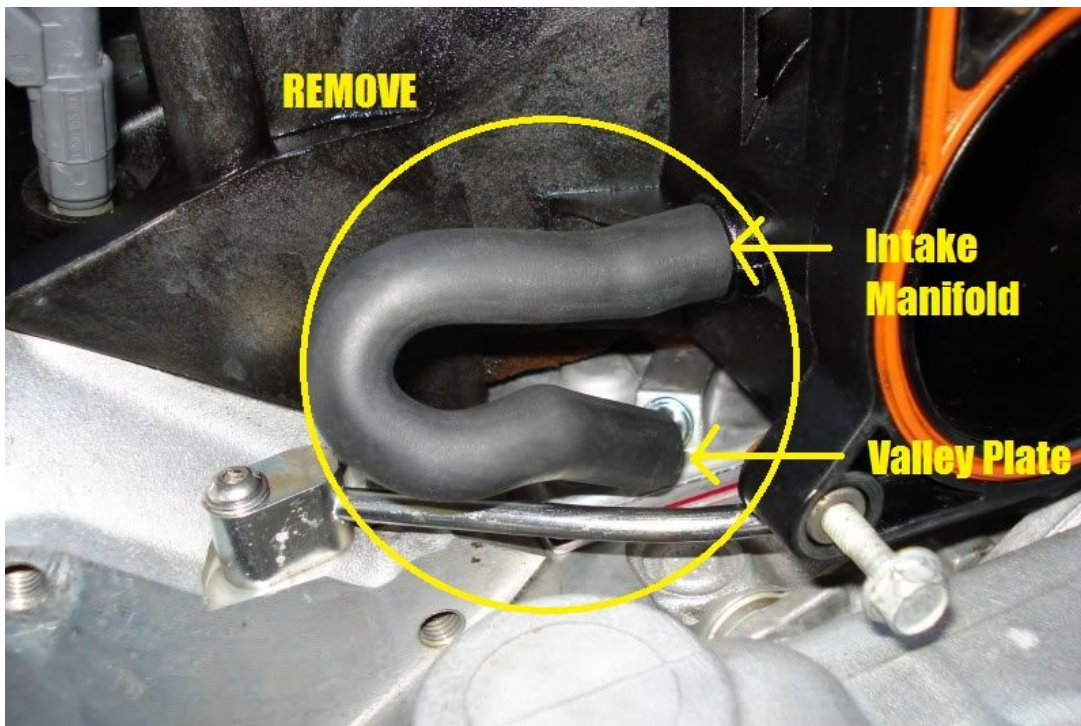

Connect can outlet to intake manifold factory PCV return port, Passenger side of intake manifold.

Some cars will have the PCV 'fresh air' port on top of the throttle body, newer cars will have it forward of the throttle body in the cold air tubing after the MAF sensor. If using the MAF sensor it is critical that the PCV air be measured before use.

If converting from a throttle body with the fresh air port at the top to a style without it, this hose must be relocated to between the throttle body and the MAF sensor, as it is placed in this same location OEM for the newer version 'DBW' throttle bodies. If you are turbo or centri-blower boosted you CANNOT connect to either the port on the

throttle body or in front, it must be moved to in front of the power adder to a non-boosted location.



LS2+ 'Mild' mightymousesolutions.com

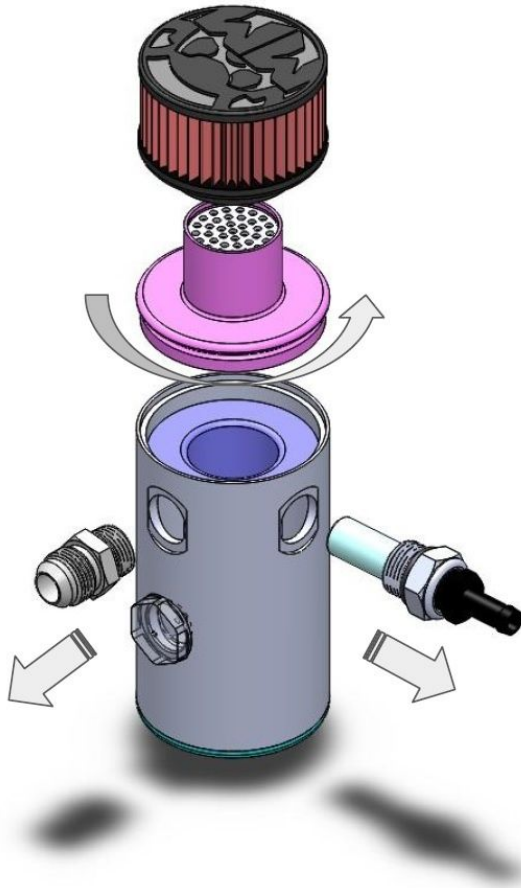
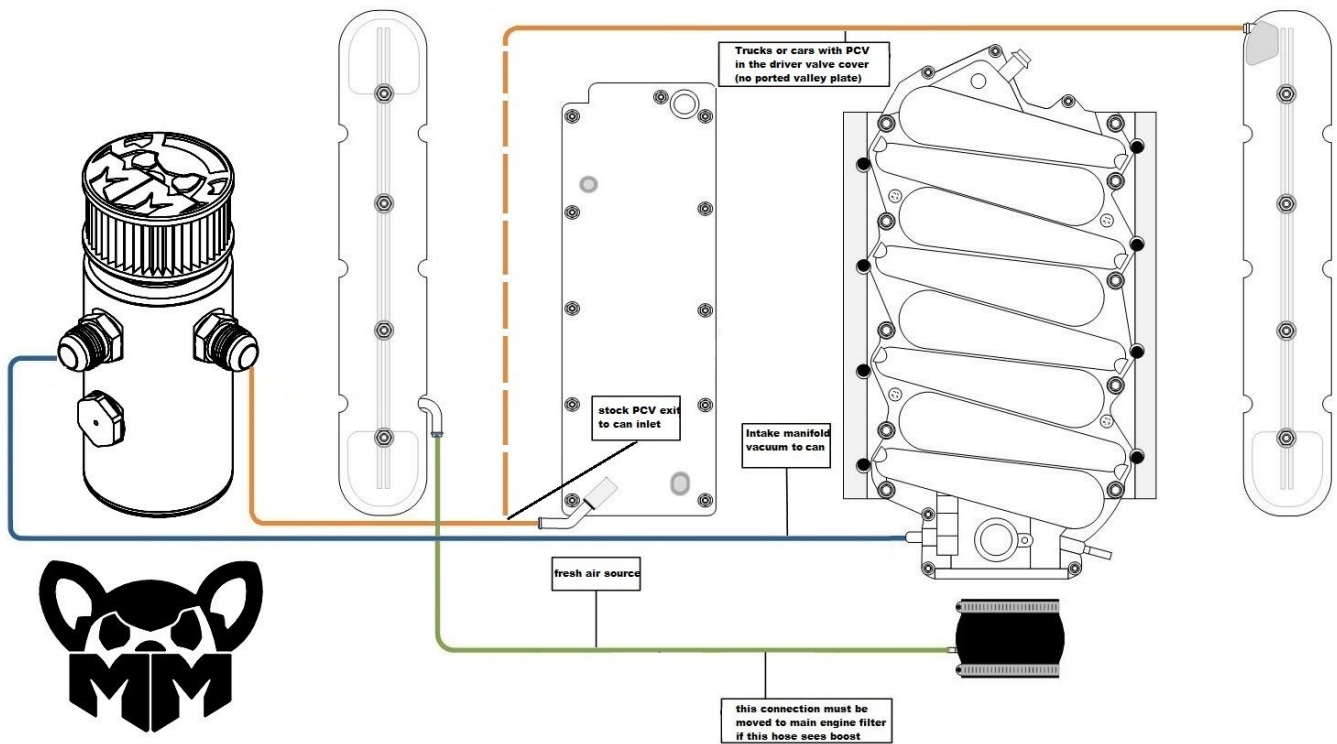

OPTIONAL DRAFT / PCV CAN FITTING SWAP

(These fittings are pre-positioned during assembly but can be changed if you prefer to improve hose layout)

-loosen clamp and pull off breather

-use 'kitchen grip' or similar to unscrew can top

-unscrew both fittings, noticing which fitting has the 'clean side' transfer tube to the can center

-rotate the can center so that the hole the transfer tube passes through aligns with new position

-reinstall fittings, can top, breather hand tight

-enjoy!